

マルチU (W=500) 縦断用固定蓋タイプ (センタースリット) U型側溝 S=1:20

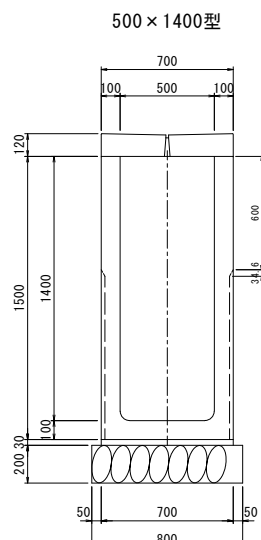

マルチU (W=500) 縦断用固定蓋タイプ (センタースリット) 自由勾配側溝 S=1:20

500 × 400型

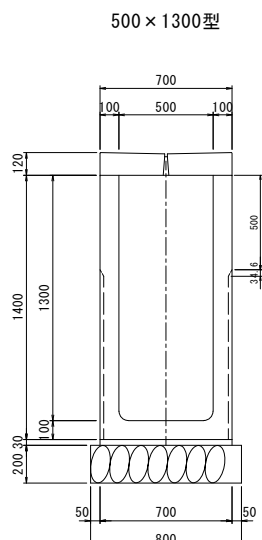
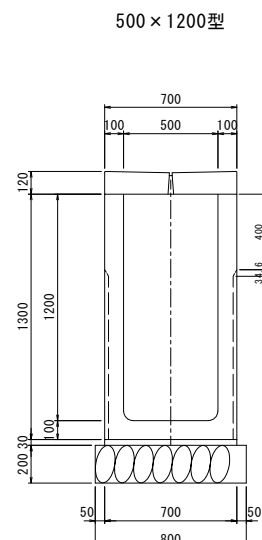
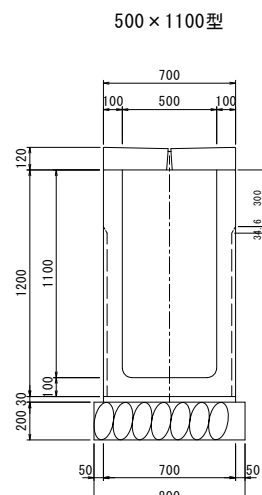
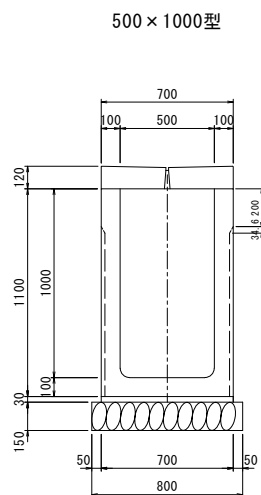
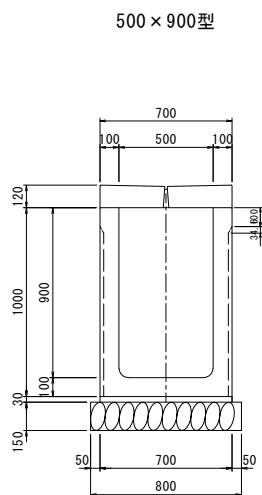
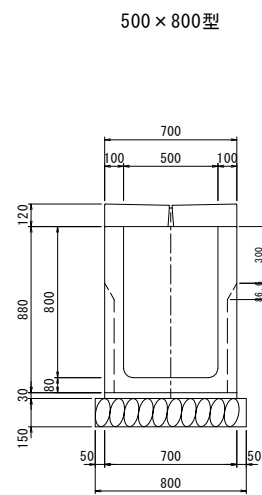
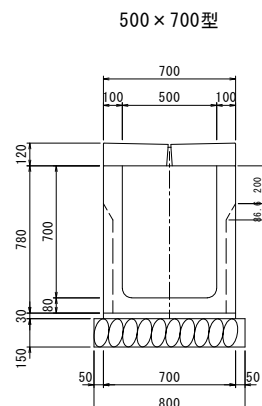
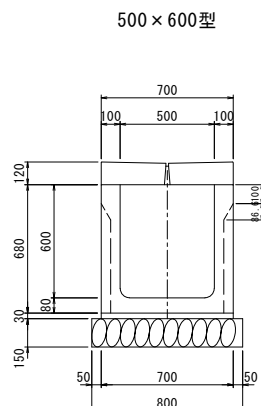
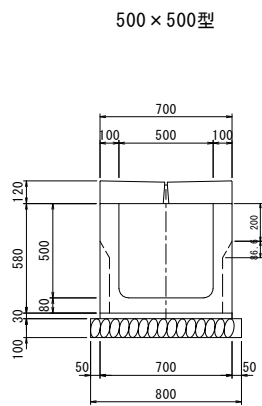
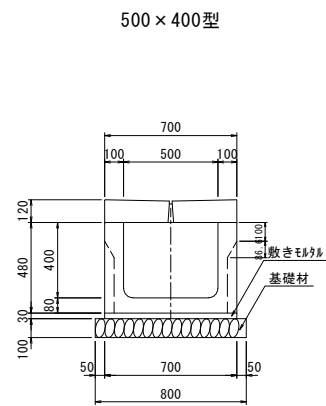
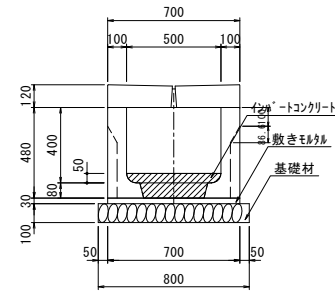

500 × 500型

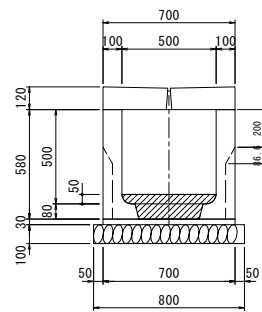

500×600型

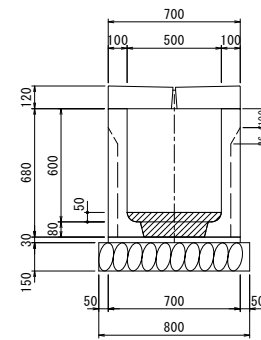

500×700型

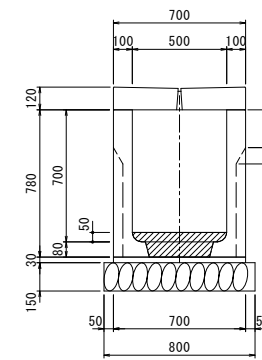

500×800型

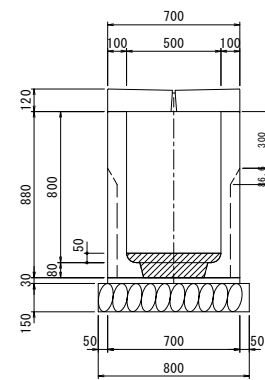

500 × 900型

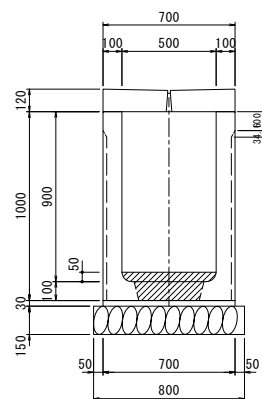

500×1000型

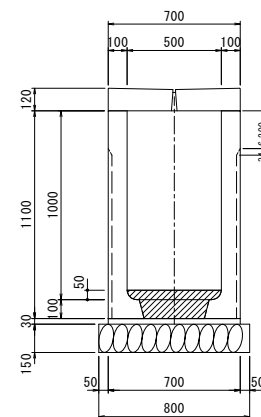

500 × 1100型

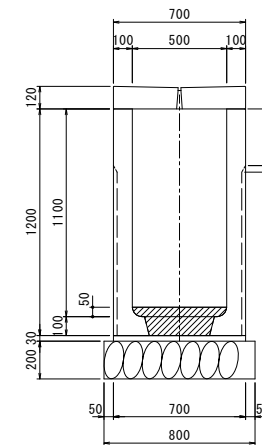

500 × 1200型

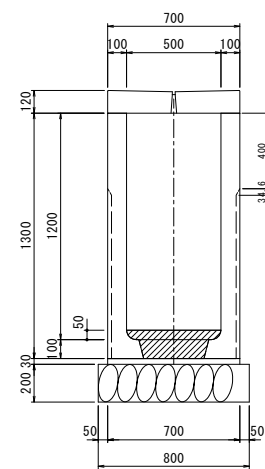

500×1300型

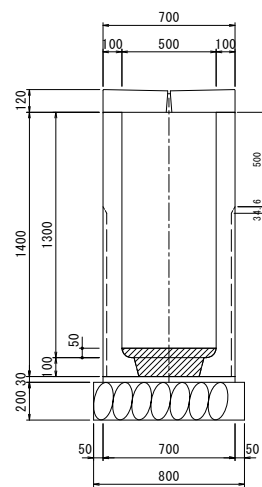

500×1400型

